

AL2A-G2 SERIES AREA LIGHT

Client:
 Project:
 Type:
 Quantity:

CONSTRUCTION

Die-cast aluminum housing with hinged die-cast aluminum door.
 Low profile, 3G vibration rated compact design minimizes wind load requirements.
 Driver enclosure cover opens downwards, completely sealed against moisture and dust.

OPTICS

UV-resistant polycarbonate optics, available in Type II, III, IV, V distributions.
 Full cutoff "U - 0" when mounted with 0 degrees tilt. Optics is precisely designed to shape the distribution, maximizing efficiency and application spacing.

ELECTRICAL

80 CRI Lumileds LED.
 Field Selectable Lumen / CCT Technology.
 -40°C up to 50°C (-40°F up to 122°F) maximum ambient temperature.
 Long-life 100,000 hr LED at L70 @ 40°C.
 Driver operates at 120-277V input, 0-10V dimmable driver, down to 10%.
 50/60Hz, <20% THD, 0.9 power factor.
 Optional 347/480V input.
 Optional 10kV surge protection.
 Optional dimming sensor for occupancy and photosensing.

SENSORS (OPTIONAL)

SENSOR-BLE-6-4T Plug-N-Play PIR ALS Control Bluetooth/on/off/dimming/photosensing.
 SENSOR-ANT-6-4T Plug-N-Play PIR on/off/dimming/photosensing.
 SENSOR-PH-PB-U Integral button style photocell.
 SENSOR-PH-PT-U/UD/HD Twist lock dimming/non-dimming photocontrol.
 CONTROL-LVFA AVI-ON Bluetooth Mesh Controller.

MOUNTING

Tilt-able pole mount bracket (SRT) suitable for both round and square pole.
 Optional slipfitter for 2-3/8" tenon (SF), adjustable trunnion mount (TR).

STANDARD FINISH

Corrosion resistant Dark Bronze powder coating finish.

CUSTOM FINISH

Corrosion resistant Black, Graphite Metallic, Gray, Silver, White, Custom RAL#.

CERTIFICATION

IP65 Wet location label standard.
 Meets Buy America Act requirements.
 IDA compliant: with 3000K color temperature selection.
 Title 24 compliant; see local ordinance for qualification information.
 All luminaires are built to UL1598 standards and bear appropriate cETLus labels.
 CE Compliance, DLC® Premium (DesignLights Consortium Qualified) listed.

WARRANTY

5 year warranty, see Limited Warranty for additional information.



450W w/SR Pole Mount



450W w/SF Mount

SHIPPING DATA

Product	Measurement	Weight
AL2A-G2-150	17"L x 13"W x 5"H	9 lb
AL2A-G2-320	24"L x 13"W x 5"H	13 lb
AL2A-G2-450	28"L x 17"W x 6"H	18 lb



AL2A-G2 SERIES AREA LIGHT

ORDER INFORMATION				EXAMPLE : AL2A-G2 150 SC T3 DB UNVD			
Fixture	Series	Power & LM	CCT	Distribution	Finish	Input	
	AL2A-G2		SC				
A	SERIES						
	AL2A-G2	AL2 Series Area Light Gen 2 Selectable					
B	POWER & LM						
	Code	Power	LM*	Efficacy (avg.)*			
	150	Field Selectable 75 / 100 / 120 / 150W	11,625 / 15,500 / 18,600 / 23,250	155lm/W			
	320	Field Selectable 160 / 200 / 240 / 320W	24,800 / 31,000 / 37,200 / 49,600	155lm/W			
	450	Field Selectable 320 / 350 / 400 / 450W	51,200 / 56,000 / 64,000 / 72,000	160lm/W			
	*LM Value & Efficacy based on 4000K, T5 Distribution						
C	CCT						
	SC	Field Selectable 3000K / 4000K / 5000K					
D	DISTRIBUTION						
	T2	Type II					
	T3	Type III					
	T4	Type IV					
	T5	Type V					
E	FINISH						
	Standard						
	DB	Dark Bronze					
	Custom Color						
	CC	BK	Black	GM	Graphite Metallic	GR	Gray
		SV	Silver	WH	White	RAL#	
F	INPUT						
	UNVD	120-277V, 0-10V Dimmable					
	UNVDCE	CE Compliance 120-277V, 0-10V Dimmable					
	HVLD	347-480V, 0-10V Dimmable					

AL2A-G2 SERIES AREA LIGHT

ORDER INFORMATION (CONTINUED)

Mounting

Accessories Options

G MOUNTING

MOUNT-AL2A-SF	Slipfitter
MOUNT-AL2A-SRT	Square/Round Pole Tilt-able
MOUNT-AL2A-TR	Trunnion Mount

H ACCESSORIES/OPTIONS

AIA	Assembled in America, compliant with BAA (COTS)
SHIELD-AL2A-A / B / C*	Backlight Shield A: 150W, B: 320W, C: 450W
SENSOR-ANT-6-4T**	Integral PIR On/Off/Dimming/Photosensing
SENSOR-BLE-6-4T**	"Plug-N-Play" Integral Bluetooth Daylight Harvesting Sensor (ALS Control Mobile App)
SENSOR-PH-PB-U**	Button Style Photocell
SENSOR-PH-PT-U / UD / HD**	Twist Lock Photocell / U: 120-277V, UD: 120-277V, HD: 480V Input
REMOTE-RC100**	Handheld Remote Commissioning Tool for SENSOR-ANT (1 per job)
SURGE-LSP4-U / H	10kV Inline Surge Protection for Universal Input / U: 120-277V, H: 480V Input
CONTROL-LVFA*	AVI-ON Bluetooth Mesh Control System
CONTROL-BLE-SK104-PH*	Integral Bluetooth Fixture Controller w/Button Photocell (ALS Control Mobile App)

*see page 5 for Shield spec

**see page 6 for Sensor spec

AL2A-G2 SERIES AREA LIGHT

DIMENSIONS

Model	L	W	H	Weight
AL2A-G2-150	15.90" (405mm)	12.00" (305mm)	2.70" (69mm)	7.7 lbs
AL2A-G2-320	22.70" (577mm)	12.00" (305mm)	2.80" (72mm)	10.8 lbs
AL2A-G2-450	24.30" (617mm)	14.80" (375mm)	3.70" (94mm)	16.5 lbs

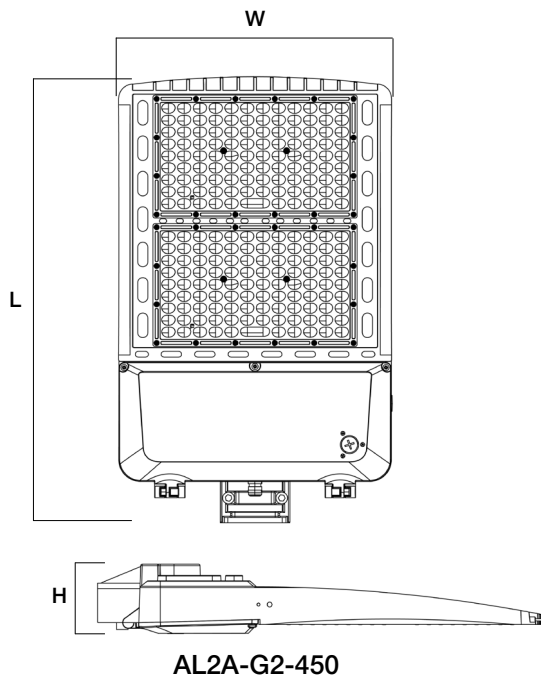
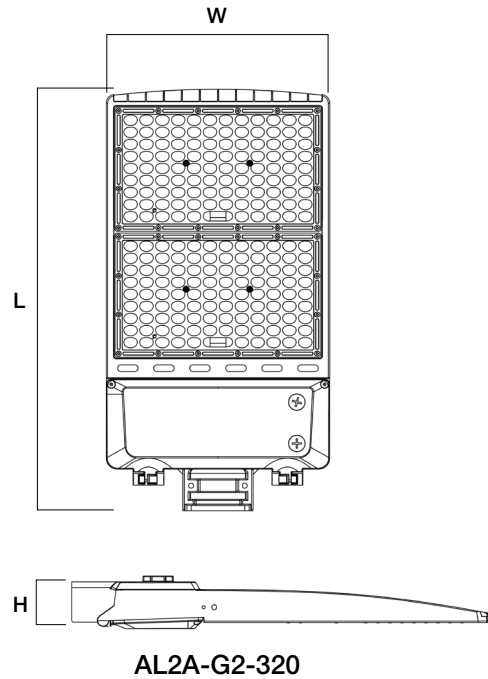
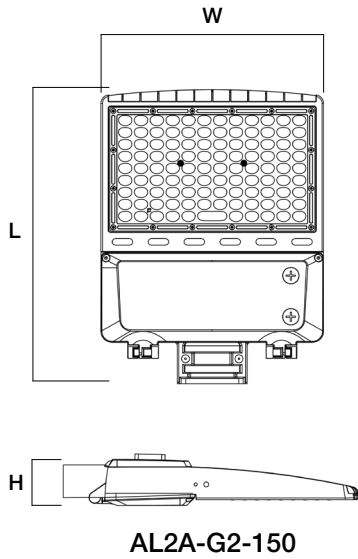

AL2A-G2 SERIES AREA LIGHT

ACCESSORIES - MOUNTING



MOUNT-AL2A-SF



MOUNT-AL2A-SRT



MOUNT-AL2A-TR

ACCESSORIES - SHIELD



SHIELD-AL2A-A / B / C

A: 150W
B: 320W
C: 450W

AL2A-G2 SERIES AREA LIGHT

SENSOR SPEC

Model	Type	Mounting	Coverage	Input	Function	Programmable
SENSOR-ANT-6-4T	PIR	up to 40FT	30FT radius	12V DC	On/Off/Dimming	REMOTE-RC100
SENSOR-BLE-6-4T (see page 9 for detail)	PIR	up to 40FT	30FT radius	12V DC	Bluetooth Mesh On/Off/Dimming Daylight Harvesting	ALS Control Bluetooth Mobile App
SENSOR-PH-PB-U	-	-	-	Universal	Dusk-to-Dawn Control	-
SENSOR-PH-PT-U	-	-	-	Universal	Dusk-to-Dawn Control	-
SENSOR-PH-PT-UD				Universal		
SENSOR-PH-PT-HD				277 ~ 480V		
CONTROL-LVFA (see page 7 for detail)	Fixture Controller	-	-	12V DC	Bluetooth Mesh On/Off/Dimming Scheduling	AVI-ON Bluetooth Mobile App
CONTROL-BLE-SK104-PH (see page 8 for detail)	Fixture Controller			12V DC	Bluetooth Mesh On/Off/Dimming Scheduling CCT Tuning	ALS Control Bluetooth Mobile App



SENSOR-ANT-6-4T
 SENSOR-BLE-6-4T



SENSOR-PH-PB-U



SENSOR-PH-PT-U/H



SENSOR-PH-PT-HD



CONTROL-LVFA



CONTROL-BLE-SK104-PH

AL2A-G2 SERIES AREA LIGHT

CONTROL-LVFA SPEC

Status LEDs & Config Button

Quick and easy validation of wiring and network

Direct Connect™ Sensor Port

Simple and cost-effective addition to Avi-on sensors

Terminal Blocks & Mounting Tabs

Faster, easier and lower cost installation eliminating connectors



Internal Antenna

Improved performance and eliminates risk of accidentally cutting a hanging wire

SPECIFICATIONS

INPUT VOLTAGE: 12-24VDC
CURRENT: 15mA without a Sensor
 19mA with a DC PIR Sensor
 48mA with a DC Microwave Sensor
0-10V DIMMING: 12-24VDC
SIZE: 2.30in x 1.43in x 0.75in
 (58.2mm x 36.4mm x 19mm)
MOUNTING: Removable mounting tabs
WEIGHT: 0.45 oz (16g)
OPERATING TEMP: -22°F to +158°F (-30°C to + 70°C)

RADIO FREQUENCY: 2.4GHz
WIRELESS STANDARD: BLE 4.2 with Mesh
POINT TO POINT RANGE*: 80ft with obstructions
 350ft unobstructed
SECURITY: AES 128-bit encryption for device to device communication
 AES 256-bit encryption for device to cloud communication
WARRANTY: 5 years; 10 years optional
REGULATORY: FCC: 2AFZI-AVI1010 B
 IC: 20544-AVI1010 B
 BQB: D031801, DID: 86303
 UL 916, 2043 (Plenum Rated)

*When communicating through the mesh, range is essentially unlimited (5000ft+)

WIRING DIAGRAM

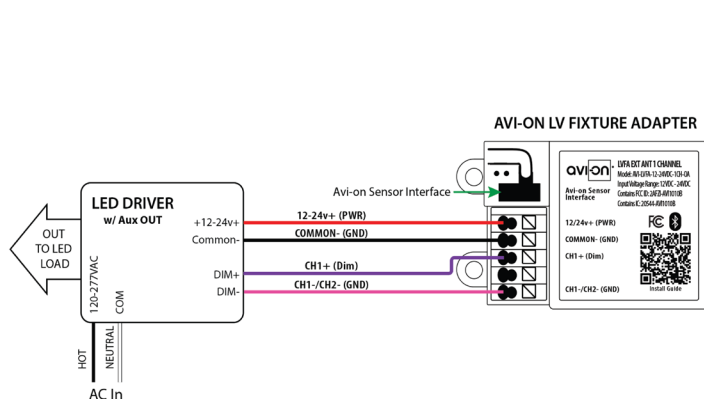

Fixture adapter powered by LED driver auxiliary output

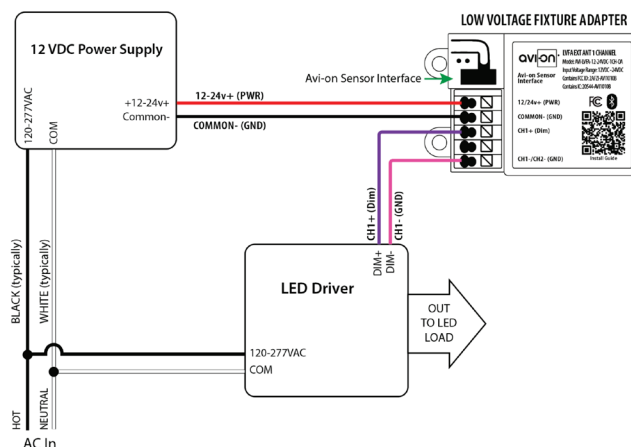

Fixture adapter connected to LED driver and using power supply

FEATURE

- **Installation:** Factory / Jobsite install through 1/2" knockout hole, 12V AUX power required
- **Commissioning:** Wirelessly through ALS Control Mobile App (iOS / Android)
- **Certification:** DLC 5.1 Networked Lighting Control System
- **Control:** High-End Trim, Zoning, Continuous Bi-level Dimming
- **CCT Tuning:** CCT Tuning feature for Dual/Multi-CCT LED board fixture only
- **Sensor:** Photocell
- **Zone Control:** Zoning and Grouping control, Scheduling



SPECIFICATIONS

SENSOR TYPE:	Photocell
WIRELESS STANDARDS:	5.0 Bluetooth Mesh
INPUT VOLTAGE:	10-14VDC, >50mA
CONTROL OUTPUT:	0-10V
OPERATING TEMP:	-40°F ~ +158°F (-40°C ~ +70°C)
COMMISSIONING RANGE:	50FT
BLUETOOTH RANGE:	100FT
DETECTION ANGLE:	360°
WARRANTY:	5 years
IP RATING:	IP65

DIMENSIONS

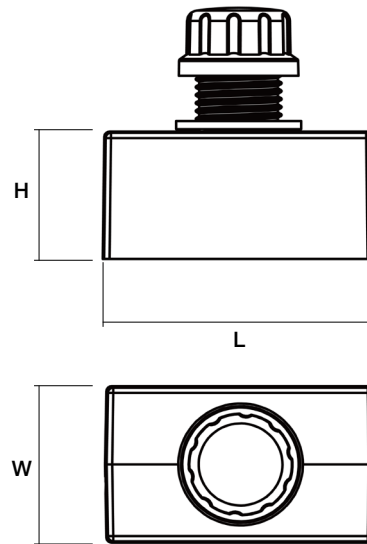

L	H	W
1.14" (29mm)	0.94" (24mm)	1.97" (50mm)

WIRING DIAGRAM

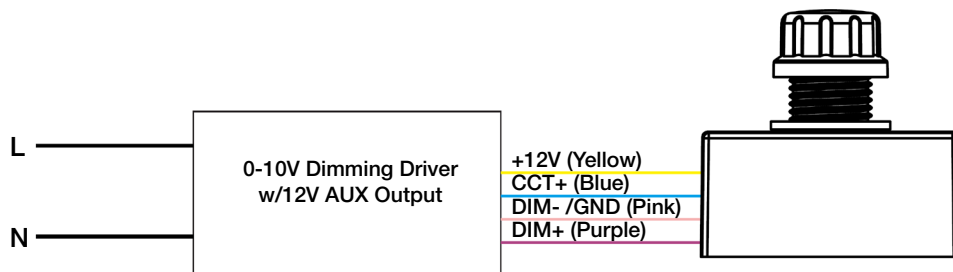



SENSOR-BLE-6-4T BLUETOOTH PIR SENSOR

Client:
Project:
Type:
Quantity:

FEATURE

- **Installation:** Plug-N-Play via AUX socket on attached fixture
- **Commissioning:** Wirelessly through ALS Control Mobile App (iOS / Android)
- **Certification:** DLC 5.1 Networked Lighting Control System
- **Control:** Hold time, High-Low setting, continuous Bi-level dimming, Code-compliant manual-on or auto-off capability
- **Sensor:** Motion (Occupancy/Vacancy/Manual) and Daylight Harvesting
- **Room and Zone Control:** Zoning and Grouping control, Scheduling



SPECIFICATIONS

SENSOR TYPE:	Passive Infrared Sensor (PIR)
WIRELESS STANDARDS:	5.0 Bluetooth Mesh
INPUT VOLTAGE:	12-24VDC, >50mA
CONTROL OUTPUT:	0-10V
OPERATING TEMP:	-4°F ~ +140°F (-20°C ~ +60°C)
COMMISSIONING RANGE:	50FT
BLUETOOTH RANGE:	164FT
DETECTION ANGLE:	360°
MOUNTING HEIGHT:	Up to 40FT
WARRANTY:	5 years
IP RATING:	IP65

DIMENSIONS

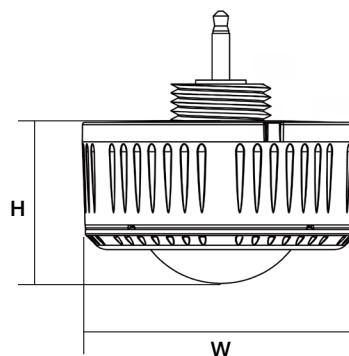

H	W
1.03" (26.2mm)	2.17" (55mm)

COVERAGE PATTERNS

