

## WNA G2 SERIES SEMI-CUTOFF WALL PACK

Client:  
 Project:  
 Type:  
 Quantity:

### CONSTRUCTION

Cast aluminum frame holds lens and seals to housing gasket with two stainless steel screws. Door assembly hinges to side, cast aluminum housing with three 1/2" conduit entries (on top and sides), for surface conduit.  
 Suitable for applications requiring 3G testing prescribed by ANSI C136.31.

### OPTICS

UV stabilized polycarbonate refractor softens LED image and provides uniform distribution and glare control.

### ELECTRICAL

70+ CRI Lumileds LED.  
 CCT and output selectable between 3000K ~ 5000K configuration settings.  
 -40°C up to 45°C (-40°F up to 113°F) maximum operating temperature.  
 150,000hr LED at L70 @ 25°C, 120,000hr LED at L70 @ 40°C.  
 Driver operates at 120-277V input, 50/60Hz, <20% THD, 0.9 power factor.  
 0-10V dimming driver, button photocontrol standard included.  
 Optional 10kV surge protector.  
 Optional Self-Diagnostic emergency back up.  
 Optional Self-Diagnostic Sub-Zero emergency back up.

### SENSORS (OPTIONAL)

CONTROL-BLE-SK104-PH ALS Control Bluetooth Fixtrue Controller.  
 CONTROL-LVFA AVI-ON Bluetooth Mesh Controller.

### MOUNTING

Wall mount over electrical box or via surface conduit.

### STANDARD FINISH

Corrosion resistant Dark Bronze powder coating finish.

### CUSTOM FINISH

Black, Graphite Metallic, Gray, Silver, and White, or custom RAL#

### CERTIFICATION

Wet Location listed.  
 3G testing prescribed by ANSI C136.31.  
 Meets Buy America Act requirements.  
 IDA compliant: with 3000K color temperature selection.  
 All luminaires are built to UL1598 standards and bear appropriate cULus labels.  
 For Emergency application, equipped with UL924 certified battery packs.  
 DLC® Premium (DesignLights Consortium Qualified) listed.

### WARRANTY

5 year warranty, see Limited Warranty for additional information.



### SHIPPING DATA

Product	Measurement	Weight
WNA-G2-65	15"L x 8"W x 10"H	7 lb
WNA-G2-100	15"L x 8"W x 10"H	8 lb



## WNA G2 SERIES SEMI-CUTOFF WALL PACK

ORDER INFORMATION					EXAMPLE: WNA G2 65 SC DB UD P		
Fixture	Series	Power & LM	CCT	Finish	Input	Sensor	
	WNA-G2		SC			P	
Accessories Options							
A	SERIES						
	WNA-G2	Selectable Semi-Cutoff Wall Pack Gen 2					
B	POWER & LM						
	Code	Power	LM				
	65	28W / 41W / 56W / 68W	4047 ~ 8334 lm				
	100	39W / 62W / 88W / 100W	5759 ~ 12123 lm				
C	CCT						
	SC	Selectable 3000K / 4000K / 5000K					
D	FINISH						
	Standard						
	DB	Dark Bronze					
	Custom Color						
	CC	BK	Black	GM	Graphite Metallic	GR	Gray
		SV	Silver	WH	White	RAL#	
E	INPUT						
	UNVD-P	120-277V, 0-10V Dimming, with Photocell					
	HVLD-P	347-480V, 0-10V Dimming, with Photocell					
G	ACCESSORIES/OPTIONS						
	AIA	Assembled in America, compliant with BAA (COTS)					
	BABAA	Build America, Buy America Act (BABAA) Compliant					
	SURGE-LSP4-U / H	10kV inline Surge Protection for Universal input / <b>U</b> : 120-277V, <b>H</b> : 480V input					
	CONTROL-BLE-SK104-PH*	Integral Bluetooth Fixture Controller w/Button Photocell (ALS Control Mobile App)					
	CONTROL-LVFA*	Integral AVI-ON Bluetooth Fixture Controller					
	EMB-8W-B**	90-Minute Self-Diagnostic Emergency Battery 8W 100-347VAC Input 170VDC Output					
	EMB-18W-B**	90-Minute Self-Diagnostic Emergency Battery 18W 100-347VAC Input 170VDC Output					
	EMB-18W-C-B**	90-Minute Self-Diagnostic Emergency Battery 18W 100-347VAC Input 170VDC Output -20°C-50°C (-4°F-122°F)					

\*see page 5 for sensor spec

\*\*see page 6 for emb spec

**WNA G2 SERIES SEMI-CUTOFF WALL PACK**

**DIMENSIONS**

Model	H	L	D
WNA-G2-65	9.25" (235mm)	14.20" (361mm)	7.08" (180mm)
WNA-G2-100	9.25" (235mm)	14.20" (361mm)	7.08" (180mm)

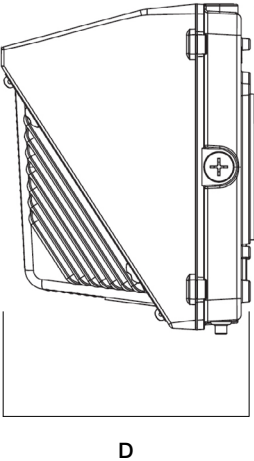
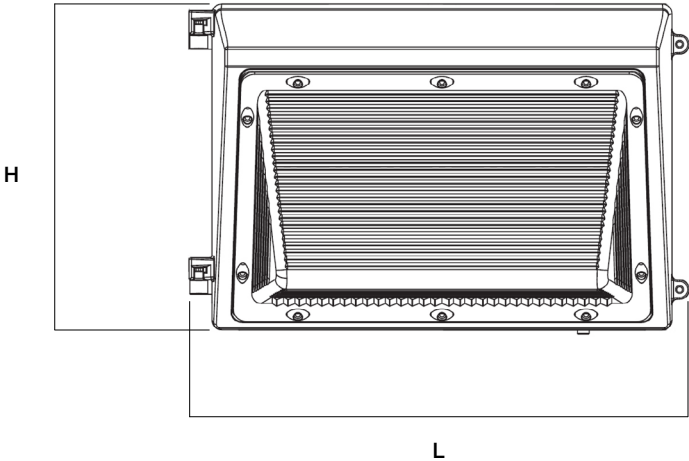



## WNA G2 SERIES SEMI-CUTOFF WALL PACK

### PERFORMANCE DATA / DLC CODE

SYSTEM WATTS	CCT	VOLTAGE	LUMEN	LPW	QTY ON PALLET	PART NUMBER	DLC PRODUCT ID / ORDER CODE	DLC CLASS
WNA-G2-65 28W Selection	4000K	120-277V	4047	155	96	WNA-G2-65MC-DBUNVD-P	PENDING	DLC 5.1 Premium
WNA-G2-65 41W Selection	4000K	120-277V	5665	146	96	WNA-G2-65MC-DBUNVD-P	PENDING	DLC 5.1 Premium
WNA-G2-65 56W Selection	4000K	120-277V	7190	137	96	WNA-G2-65MC-DBUNVD-P	PENDING	DLC 5.1 Premium
WNA-G2-65 68W Selection	4000K	120-277V	8334	131	96	WNA-G2-65MC-DBUNVD-P	PENDING	DLC 5.1 Premium
WNA-G2-100 39W Selection	4000K	120-277V	5759	157	96	WNA-G2-100MC-DBUNVD-P	PENDING	DLC 5.1 Premium
WNA-G2-100 62W Selection	4000K	120-277V	8566	146	96	WNA-G2-100MC-DBUNVD-P	PENDING	DLC 5.1 Premium
WNA-G2-100 88W Selection	4000K	120-277V	11094	134	96	WNA-G2-100MC-DBUNVD-P	PENDING	DLC 5.1 Premium
WNA-G2-100 100W Selection	4000K	120-277V	12123	129	96	WNA-G2-100MC-DBUNVD-P	PENDING	DLC 5.1 Premium

**WNA G2 SERIES SEMI-CUTOFF WALL PACK**

**SENSOR SPEC**

Model	Type	Mounting	Coverage	Input	Function	Programmable
CONTROL-BLE-SK104-PH (see page 8 for detail)	Fixture Controller	-	-	12V DC	Bluetooth Mesh On/Off/Dimming Scheduling CCT Tuning	ALS Control Bluetooth Mobile App
CONTROL-LVFA (see page 7 for detail)	Fixture Controller	-	-	12V DC	Bluetooth Mesh On/Off/Dimming Scheduling	AVI-ON Bluetooth Mobile App
 	CONTROL-BLE-SK104-PH	CONTROL-AVI-LVFA				

## WNA G2 SERIES SEMI-CUTOFF WALL PACK

### EMB SPEC

Model	Battery Capacity	Input	Output	Output Power	Operating Temp	Installation
EMB-8W-B	90mins	100-347VAC	170VDC	8W	0°C ~ 50°C 32°F ~ 122°F	Factory or Field Install
EMB-18W-B	90mins	100-347VAC	170VDC	18W	0°C ~ 50°C 32°F ~ 122°F	Factory or Field Install
EMB-18W-C-B	90mins	100-347VAC	170VDC	18W	-20°C ~ 50°C -4°F ~ 122°F	Factory or Field Install

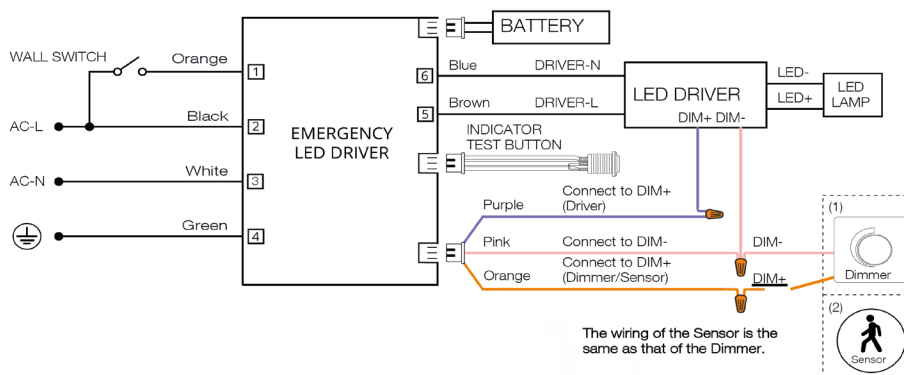

## WNA G2 SERIES SEMI-CUTOFF WALL PACK

### CONTROL-LVFA SPEC

#### Status LEDs & Config Button

Quick and easy validation of wiring and network

#### Direct Connect™ Sensor Port

Simple and cost-effective addition to Avi-on sensors

#### Terminal Blocks & Mounting Tabs

Faster, easier and lower cost installation eliminating connectors



#### Internal Antenna

Improved performance and eliminates risk of accidentally cutting a hanging wire

### SPECIFICATIONS

**INPUT VOLTAGE:** 12-24VDC  
**CURRENT:** 15mA without a Sensor  
 19mA with a DC PIR Sensor  
 48mA with a DC Microwave Sensor  
**0-10V DIMMING:** 12-24VDC  
**SIZE:** 2.30in x 1.43in x 0.75in  
 (58.2mm x 36.4mm x 19mm)  
**MOUNTING:** Removable mounting tabs  
**WEIGHT:** 0.45 oz (16g)  
**OPERATING TEMP:** -22°F to +158°F (-30°C to + 70°C)

**RADIO FREQUENCY:** 2.4GHz  
**WIRELESS STANDARD:** BLE 4.2 with Mesh  
**POINT TO POINT RANGE\*:** 80ft with obstructions  
 350ft unobstructed  
**SECURITY:** AES 128-bit encryption for device to device communication  
 AES 256-bit encryption for device to cloud communication  
**WARRANTY:** 5 years; 10 years optional  
**REGULATORY:** FCC: 2AFZI-AV1010 B  
 IC: 20544-AV1010 B  
 BQB: D031801, DID: 86303  
 UL 916, 2043 (Plenum Rated)

\*When communicating through the mesh, range is essentially unlimited (5000ft+)

### WIRING DIAGRAM

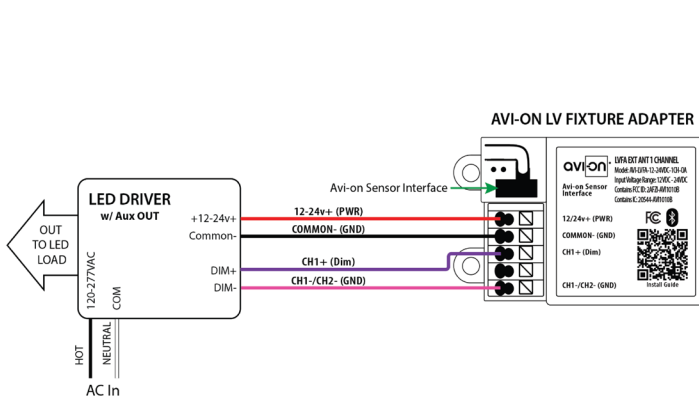

Fixture adapter powered by LED driver auxiliary output

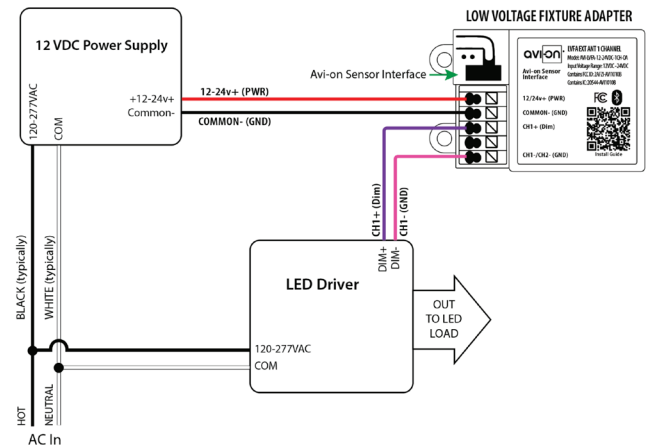

Fixture adapter connected to LED driver and using power supply

### FEATURE

- **Installation:** Factory / Jobsite install through 1/2" knockout hole, 12V AUX power required
- **Commissioning:** Wirelessly through ALS Control Mobile App (iOS / Android)
- **Certification:** DLC 5.1 Networked Lighting Control System
- **Control:** High-End Trim, Zoning, Continuous Bi-level Dimming
- **CCT Tuning:** CCT Tuning feature for Dual/Multi-CCT LED board fixture only
- **Sensor:** Photocell
- **Zone Control:** Zoning and Grouping control, Scheduling



### SPECIFICATIONS

SENSOR TYPE:	Photocell
WIRELESS STANDARDS:	5.0 Bluetooth Mesh
INPUT VOLTAGE:	12-14VDC, >50mA
CONTROL OUTPUT:	0-10V
OPERATING TEMP:	-40°F ~ +158°F (-40°C ~ +70°C)
COMMISSIONING RANGE:	50FT
BLUETOOTH RANGE:	100FT
DETECTION ANGLE:	360°
WARRANTY:	5 years
IP RATING:	IP65

### DIMENSIONS

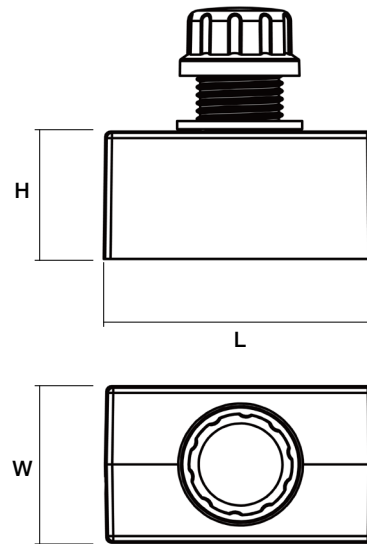

L	H	W
1.14" (29mm)	0.94" (24mm)	1.97" (50mm)

### WIRING DIAGRAM

