

INSTALLATION INSTRUCTIONS FOR LED EMERGENCY EXIT LIGHT

SAVE THESE INSTRUCTIONS IMPORTANT SAFEGUARDS:

When using electrical equipment, always adhere to basic safety precautions including the following:

IMPORTANT

The battery in this unit may not be fully charged. After electricity is connected to unit, let battery charge for at least 24 hours, then normal operation of this unit should take effect. When re-lamping, use only LED lamps specified in the fixture. Using other lamp types may result in transformer damage or unsafe conditions.

READ AND FOLLOW ALL SAFETY INSTRUCTIONS

1. Do not use outdoors.
2. Equipment should be mounted securely in locations and at heights where it will not be readily subjected to tampering by unauthorized personnel.
3. Do not mount near gas or electric heaters.
4. Cap unused wires with enclosed wire nuts or other approved method.
5. Do not use this equipment for anything other than its intended use.
6. The use of accessory equipment not recommended by the manufacturer will void product listing and warranty and may cause an unsafe condition.
7. Disconnect AC power before servicing and installation.
8. Consult local building code for approved wiring and installation.
9. Use caution when servicing batteries.
10. Any service on this equipment should be performed by qualified personnel only.
11. Make sure wire terminations are secure and leads are properly tucked in appropriate wire channels.

Installation

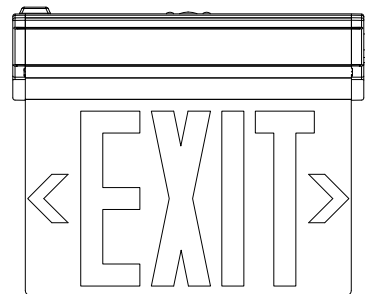
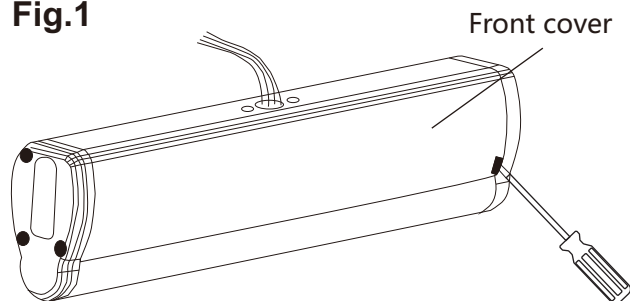
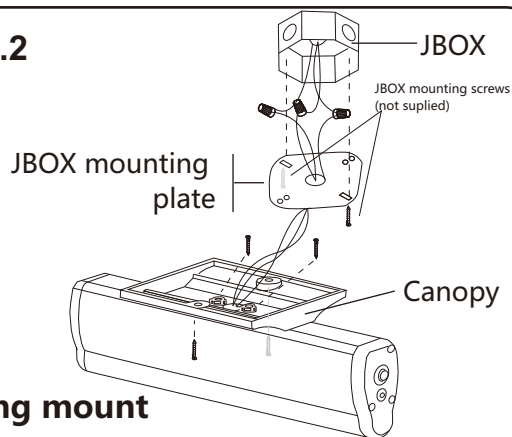

Fig.1



Use screwdriver open front cover

Fig.2



Ceiling mount

Fig.3

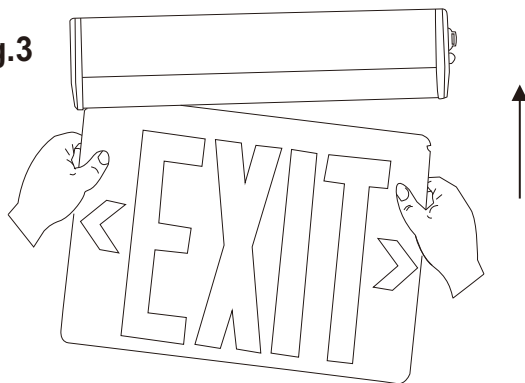

**Insert EXIT panel into main body
and determine direction for chevron placement**

Fig.4

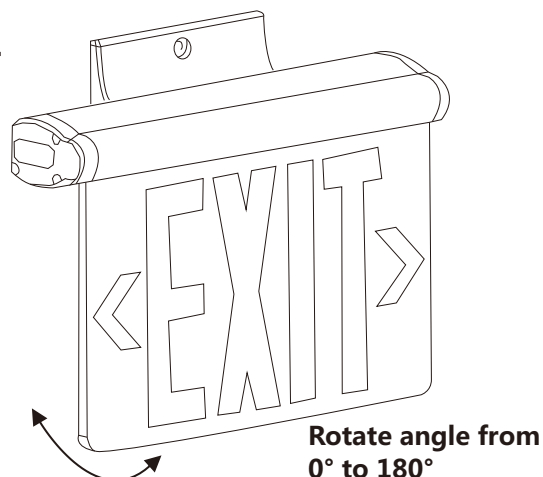

**Rotate angle from
0° to 180°**

Fig.5

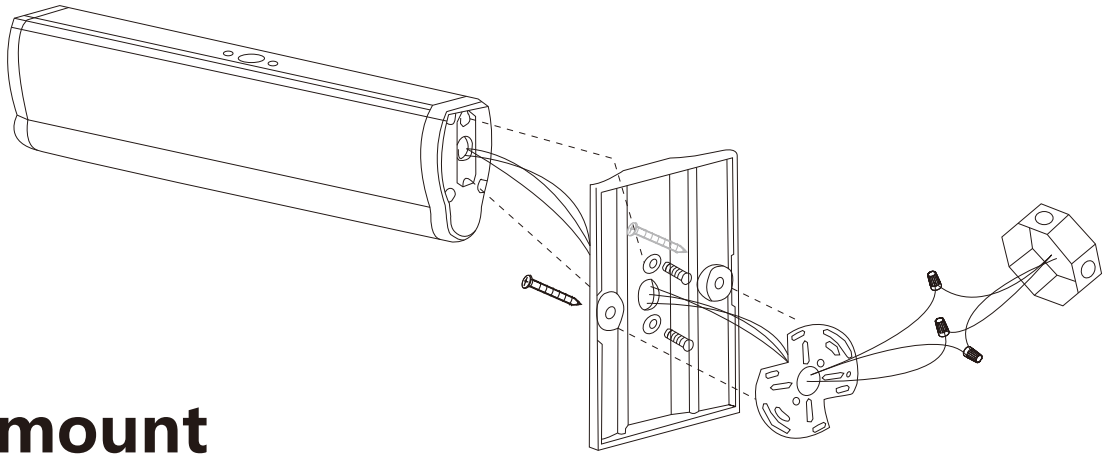

Side mount

Fig.6

- 1.Make wire connections using the wire nuts
- 2.For 120V applications, use the black and white wires.
- 3.For 277V applications, use the red and white wires.
- 4.Cap the unused wire using a wire nut.

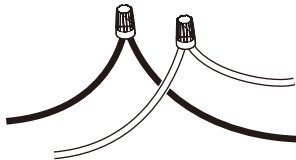

BATTERY REPLACEMENT

This fixture uses a Ni-MH Rechargeable AAA 600 mAh 4.8V battery.

To remove the battery:

- 1.Bend the battery catches away from the battery and remove the battery from the housing.
- 2.Disconnect the battery leads from the board terminal.
- 3.Connect the new battery to the board terminal.
- 4.Place the new battery in the battery location and ensure it is seated behind the battery catches.

TROUBLESHOOTING

Problem	Possible Cause	Solution
The LED charge indicator does not illuminate.	AC power supply is off.	Ensure the unit has AC power supply. Restore the power at the breaker/fuse box.
	The unit is incorrectly wired.	Ensure the unit is wired correctly.
	The battery isn't connected.	Ensure the battery is connected.
The LED emergency heads do not illuminate.	The battery is discharged.	Verify the unit is properly wired and connected to an AC power source. Allow the unit to charge for 24 hours and then re-test.
	The battery isn't connected.	Ensure the battery is connected.