

WNA G2 SERIES SEMI-CUTOFF WALL PACK

Client:
 Project:
 Type:
 Quantity:

CONSTRUCTION

Cast aluminum frame holds lens and seals to housing gasket with two stainless steel screws. Door assembly hinges to side, cast aluminum housing with three 1/2" conduit entries (on top and sides), for surface conduit.
 Suitable for applications requiring 3G testing prescribed by ANSI C136.31.

OPTICS

UV stabilized polycarbonate refractor softens LED image and provides uniform distribution and glare control.

ELECTRICAL

70+ CRI Lumileds LED.
 CCT and output selectable between 3000K ~ 5000K configuration settings.
 -40°C up to 45°C (-40°F up to 113°F) maximum operating temperature.
 150,000hr LED at L70 @ 25°C, 120,000hr LED at L70 @ 40°C.
 Driver operates at 120-277V input, 50/60Hz, <20% THD, 0.9 power factor.
 0-10V dimming driver, button photocontrol standard included.
 Optional 10kV surge protector.
 Optional Self-Diagnostic emergency back up.
 Optional Self-Diagnostic Sub-Zero emergency back up.

SENSORS (OPTIONAL)

CONTROL-BLE-SK104-PH ALS Control Bluetooth Fixtrue Controller.
 CONTROL-LVFA AVI-ON Bluetooth Mesh Controller.

MOUNTING

Wall mount over electrical box or via surface conduit.

STANDARD FINISH

Corrosion resistant Dark Bronze powder coating finish.

CUSTOM FINISH

Black, Graphite Metallic, Gray, Silver, and White, or custom RAL#

CERTIFICATION

Wet Location listed.
 3G testing prescribed by ANSI C136.31.
 Meets Buy America Act requirements.
 IDA compliant: with 3000K color temperature selection.
 All luminaires are built to UL1598 standards and bear appropriate cULus labels.
 For Emergency application, equipped with UL924 certified battery packs.
 DLC® Premium (DesignLights Consortium Qualified) listed.

WARRANTY

5 year warranty, see Limited Warranty for additional information.



SHIPPING DATA

Product	Measurement	Weight
WNA-G2-65	15"L x 8"W x 10"H	7 lb
WNA-G2-100	15"L x 8"W x 10"H	8 lb



WNA G2 SERIES SEMI-CUTOFF WALL PACK

ORDER INFORMATION					EXAMPLE: WNA G2 65 SC DB UD P	
Fixture	Series	Power & LM	CCT	Finish	Input	Sensor
	WNA-G2		SC			P
Accessories Options						
A	SERIES					
	WNA-G2	Selectable Semi-Cutoff Wall Pack Gen 2				
B	POWER & LM					
	Code	Power	LM			
	65	28W / 41W / 56W / 68W	4047 ~ 8334 lm			
	100	39W / 62W / 88W / 100W	5759 ~ 12123 lm			
C	CCT					
	SC	Selectable 3000K / 4000K / 5000K				
D	FINISH					
	Standard					
	DB	Dark Bronze				
	Custom Color					
	CC	BK Black	GM Graphite Metallic	GR Gray		
		SV Silver	WH White	RAL#		
E	INPUT					
	UNVD-P	120-277V, 0-10V Dimming, with Photocell				
	HVLD-P	347-480V, 0-10V Dimming, with Photocell				
G	ACCESSORIES/OPTIONS					
	AIA	Assembled in America, compliant with BAA (COTS)				
	SURGE-LSP4-U / H	10kV inline Surge Protection for Universal input / U : 120-277V, H : 480V input				
	CONTROL-BLE-SK104-PH*	Integral Bluetooth Fixture Controller w/Button Photocell (ALS Control Mobile App)				
	CONTROL-LVFA*	Integral AVI-ON Bluetooth Fixture Controller				
	EMB-8W-B**	Self-Diagnostic Emergency Battery 8W 100-347VAC Input 170VDC Output				
	EMB-18W-B**	Self-Diagnostic Emergency Battery 18W 100-347VAC Input 170VDC Output				
	EMB-18W-C-B**	Self-Diagnostic Cold Weather Emergency Battery 18W 100-347VAC Input 170VDC Output (-20°C ~ 50°C)				

*see page 5 for sensor spec

**see page 6 for emb spec

WNA G2 SERIES SEMI-CUTOFF WALL PACK

DIMENSIONS

Model	H	L	D
WNA-G2-65	9.25" (235mm)	14.20" (361mm)	7.08" (180mm)
WNA-G2-100	9.25" (235mm)	14.20" (361mm)	7.08" (180mm)

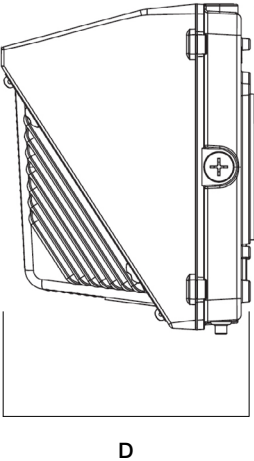
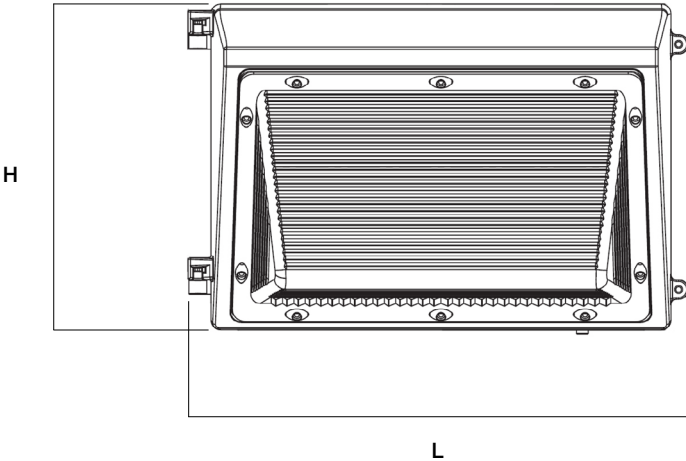



WNA G2 SERIES SEMI-CUTOFF WALL PACK

PERFORMANCE DATA / DLC CODE

SYSTEM WATTS	CCT	VOLTAGE	LUMEN	LPW	QTY ON PALLET	PART NUMBER	DLC PRODUCT ID / ORDER CODE	DLC CLASS
WNA-G2-65 28W Selection	4000K	120-277V	4047	155	96	WNA-G2-65MC-DBUNVD-P	PENDING	DLC 5.1 Premium
WNA-G2-65 41W Selection	4000K	120-277V	5665	146	96	WNA-G2-65MC-DBUNVD-P	PENDING	DLC 5.1 Premium
WNA-G2-65 56W Selection	4000K	120-277V	7190	137	96	WNA-G2-65MC-DBUNVD-P	PENDING	DLC 5.1 Premium
WNA-G2-65 68W Selection	4000K	120-277V	8334	131	96	WNA-G2-65MC-DBUNVD-P	PENDING	DLC 5.1 Premium
WNA-G2-100 39W Selection	4000K	120-277V	5759	157	96	WNA-G2-100MC-DBUNVD-P	PENDING	DLC 5.1 Premium
WNA-G2-100 62W Selection	4000K	120-277V	8566	146	96	WNA-G2-100MC-DBUNVD-P	PENDING	DLC 5.1 Premium
WNA-G2-100 88W Selection	4000K	120-277V	11094	134	96	WNA-G2-100MC-DBUNVD-P	PENDING	DLC 5.1 Premium
WNA-G2-100 100W Selection	4000K	120-277V	12123	129	96	WNA-G2-100MC-DBUNVD-P	PENDING	DLC 5.1 Premium

WNA G2 SERIES SEMI-CUTOFF WALL PACK

SENSOR SPEC

Model	Type	Mounting	Coverage	Input	Function	Programmable
CONTROL-BLE-SK104-PH (see page 8 for detail)	Fixture Controller	-	-	12V DC	Bluetooth Mesh On/Off/Dimming Scheduling CCT Tuning	ALS Control Bluetooth Mobile App
CONTROL-LVFA (see page 7 for detail)	Fixture Controller	-	-	12V DC	Bluetooth Mesh On/Off/Dimming Scheduling	AVI-ON Bluetooth Mobile App
 	CONTROL-BLE-SK104-PH	CONTROL-AVI-LVFA				

WNA G2 SERIES SEMI-CUTOFF WALL PACK

EMB SPEC

Model	Battery Capacity	Input	Output	Output Power	Operating Temp	Installation
EMB-8W-B	90mins	100-347VAC	170VDC	8W	0°C ~ 50°C 32°F ~ 122°F	Factory or Field Install
EMB-18W-B	90mins	100-347VAC	170VDC	18W	0°C ~ 50°C 32°F ~ 122°F	Factory or Field Install
EMB-18W-C-B	90mins	100-347VAC	170VDC	18W	-20°C ~ 50°C -4°F ~ 122°F	Factory or Field Install

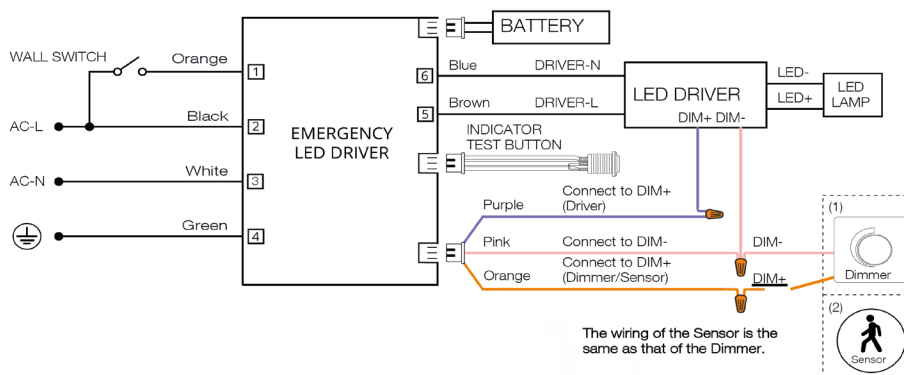

WNA G2 SERIES SEMI-CUTOFF WALL PACK

CONTROL-LVFA SPEC

Status LEDs & Config Button

Quick and easy validation of wiring and network

Direct Connect™ Sensor Port

Simple and cost-effective addition to Avi-on sensors

Terminal Blocks & Mounting Tabs

Faster, easier and lower cost installation eliminating connectors



Internal Antenna

Improved performance and eliminates risk of accidentally cutting a hanging wire

SPECIFICATIONS

INPUT VOLTAGE: 12-24VDC
CURRENT: 15mA without a Sensor
 19mA with a DC PIR Sensor
 48mA with a DC Microwave Sensor
0-10V DIMMING: 12-24VDC
SIZE: 2.30in x 1.43in x 0.75in
 (58.2mm x 36.4mm x 19mm)
MOUNTING: Removable mounting tabs
WEIGHT: 0.45 oz (16g)
OPERATING TEMP: -22°F to +158°F (-30°C to + 70°C)

RADIO FREQUENCY: 2.4GHz
WIRELESS STANDARD: BLE 4.2 with Mesh
POINT TO POINT RANGE*: 80ft with obstructions
 350ft unobstructed
SECURITY: AES 128-bit encryption for device to device communication
 AES 256-bit encryption for device to cloud communication
WARRANTY: 5 years; 10 years optional
REGULATORY: FCC: 2AFZI-AVI1010 B
 IC: 20544-AVI1010 B
 BQB: D031801, DID: 86303
 UL 916, 2043 (Plenum Rated)

*When communicating through the mesh, range is essentially unlimited (5000ft+)

WIRING DIAGRAM

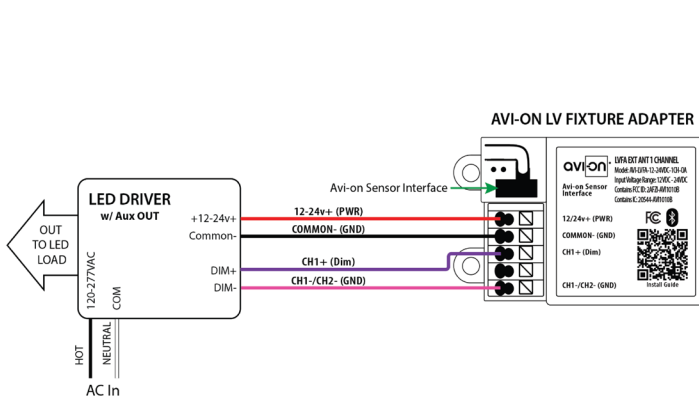

Fixture adapter powered by LED driver auxiliary output

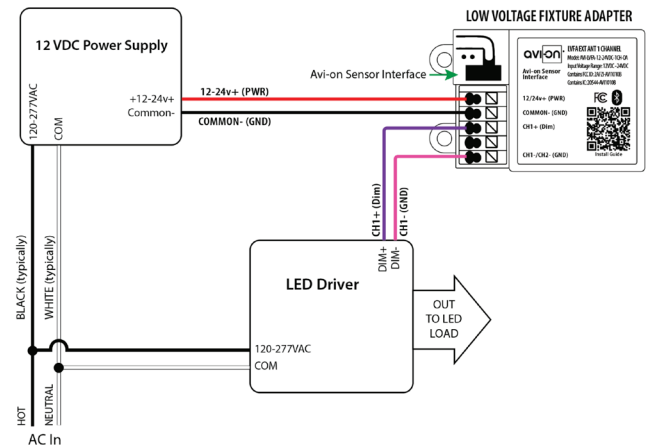

Fixture adapter connected to LED driver and using power supply

WNA G2 SERIES SEMI-CUTOFF WALL PACK

FEATURE

- **Installation:** Factory / Jobsite install through 1/2" knockout hole, 12V AUX power required
- **Commissioning:** Wirelessly through ALS Control Mobile App (iOS / Android)
- **Certification:** DLC 5.1 Networked Lighting Control System
- **Control:** High-End Trim, Zoning, Continuous Bi-level Dimming
- **CCT Tuning:** CCT Tuning feature for Dual/Multi-CCT LED board fixture only
- **Sensor:** Photocell
- **Zone Control:** Zoning and Grouping control, Scheduling



SPECIFICATIONS

SENSOR TYPE:	Photocell
WIRELESS STANDARDS:	5.0 Bluetooth Mesh
INPUT VOLTAGE:	12-14VDC, >50mA
CONTROL OUTPUT:	0-10V
OPERATING TEMP:	-40°F ~ +158°F (-40°C ~ +70°C)
COMMISSIONING RANGE:	50FT
BLUETOOTH RANGE:	100FT
DETECTION ANGLE:	360°
WARRANTY:	5 years
IP RATING:	IP65

DIMENSIONS

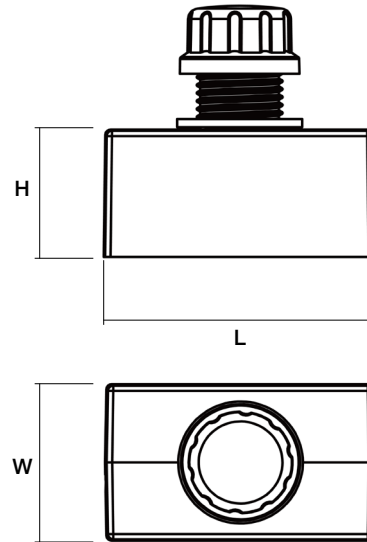

L	H	W
1.14" (29mm)	0.94" (24mm)	1.97" (50mm)

WIRING DIAGRAM

